

# TOWN OF LONGMEADOW ZONING BY-LAWS FENCING REGULATIONS

PROPERTY LINE

FENCING ALLOWED IN THIS AREA  
 CHAIN LINK UP TO 6' HIGH \*  
 SPACED PICKET UP TO 4' HIGH \*\*\*\*  
 STOCKADE UP TO 6'-6" HIGH  
 LATTICE UP TO 6'-6" HIGH \*\*\*  
 POST & RAIL UP TO 4' HIGH \*\*

PLANTINGS IN LIEU OF A FENCE:  
 NO HEIGHT RESTRICTION

CHAIN LINK, PICKET & STOCKADE MAY INCREASE  
 TO 10' HIGH IF SURROUNDING POOL OR TENNIS  
 COURT IN REAR YARD ONLY

SECONDARY SETBACK LINE

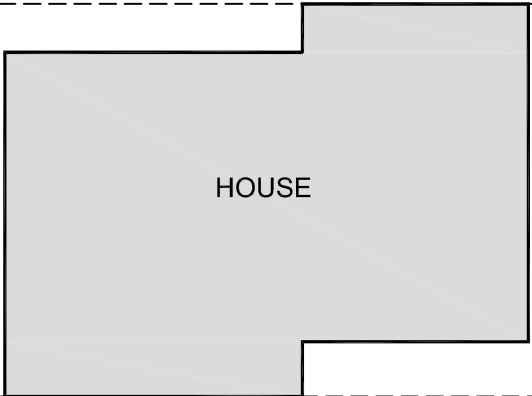

HOUSE

FENCING ALLOWED IN THIS AREA  
 CHAIN LINK UP TO 4' HIGH \*  
 POST AND RAIL UP TO 3' HIGH \*\*  
 LATTICE UP TO 4' HIGH \*\*\*  
 SPACED PICKET UP TO 4' HIGH \*\*\*\*  
 STOCKADE UP TO 4' HIGH

PLANTINGS IN LIEU OF A FENCE:  
 4' HIGH

PRIMARY SETBACK LINE

NO FENCING ALLOWED IN THIS AREA INCLUDING  
 MASONRY & STONE WALLS & PRIVACY HEDGES

PROPERTY LINE      STREET LINE

TREE BELT (VARIES)

PAVED PUBLIC STREET

**NOTE;**  
 \* WIRE MESH, IF AT LEAST 80% OPEN SPACE  
 \*\* RAIL, HAVING NOT MORE THAN 3 HORIZONTAL BARS  
 \*\*\* LATTICE, SHOWING A MINIMUM OF (50%) OPEN  
 \*\*\*\* PICKET, SHOWING A MINIMUM OF (50%) OPEN

APPROVED BY TOWN COUNCIL  
 JUNE 19,2003